

5.2.1 Hammerwerk

Umwandlung einer Drehbewegung in eine Schwingbewegung

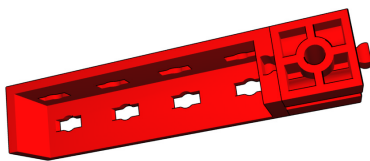

1. Drehgelenk

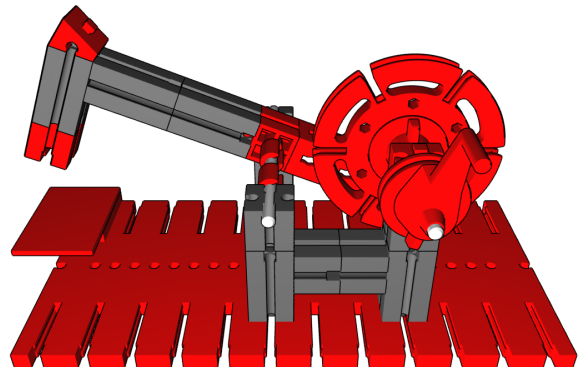
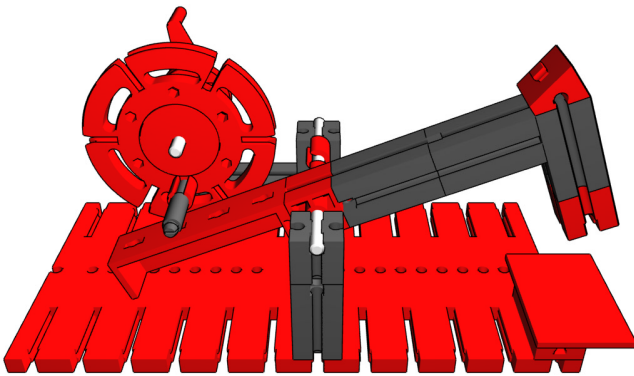
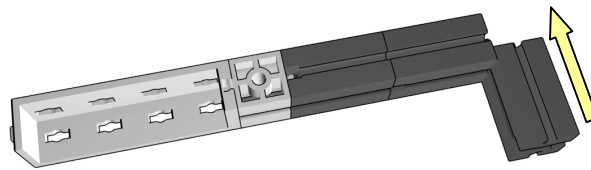

2. vollständiger Hebel

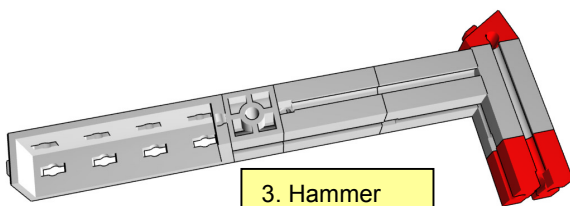

3. Hammer

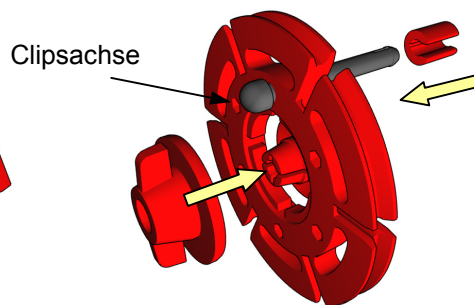

Clipsachse

Lagerhülse

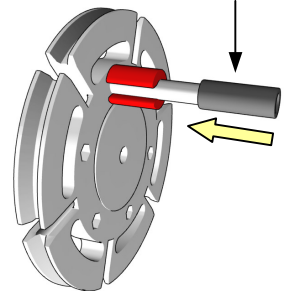

4. Scheibe mit Exzenterbolzen

Baustein 15 mit 2 Zapfen

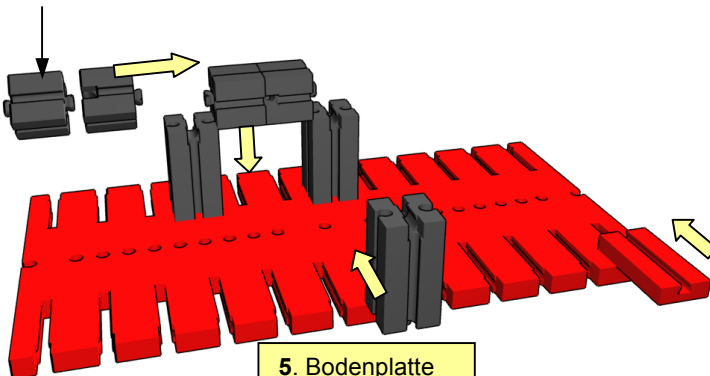

5. Bodenplatte

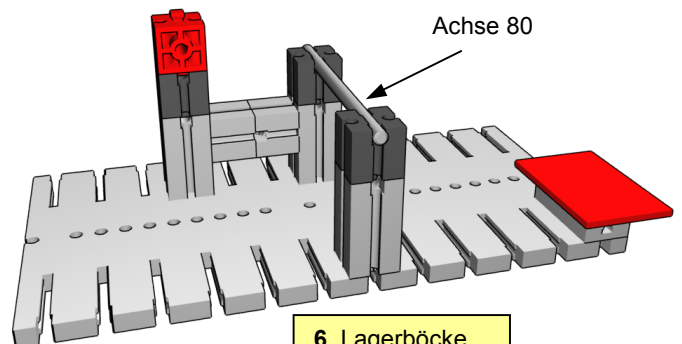

Achse 80

6. Lagerböcke

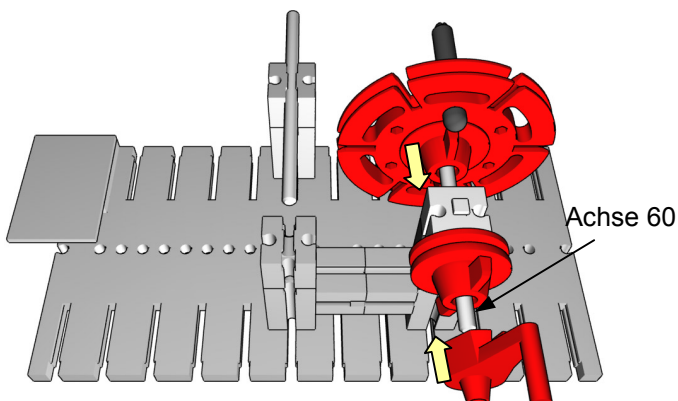

Achse 60

7. Einbau der Exzenter Scheibe mit Kurbel

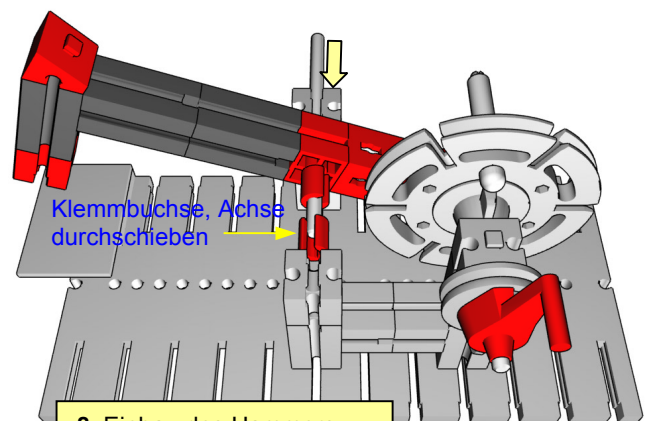

Klemmbuchse, Achse durchschieben

8. Einbau des Hammers